

# F

## Inspecting surfaces from a normal viewing position

Generally, variations in the surface colour, texture and finish of walls, ceilings, floors and roofs, and variations in glass and similar transparent materials are to be viewed where possible from a normal viewing position. A normal viewing position is looking at a distance of 1.5m or greater (600mm for appliances and fixtures) with the surface or material being illuminated by 'non-critical light'<sup>1</sup>. Non-critical light means the light that strikes the surface is diffused and is not glancing or parallel to that surface.

### DIAGRAM F NORMAL VIEWING POSITIONS

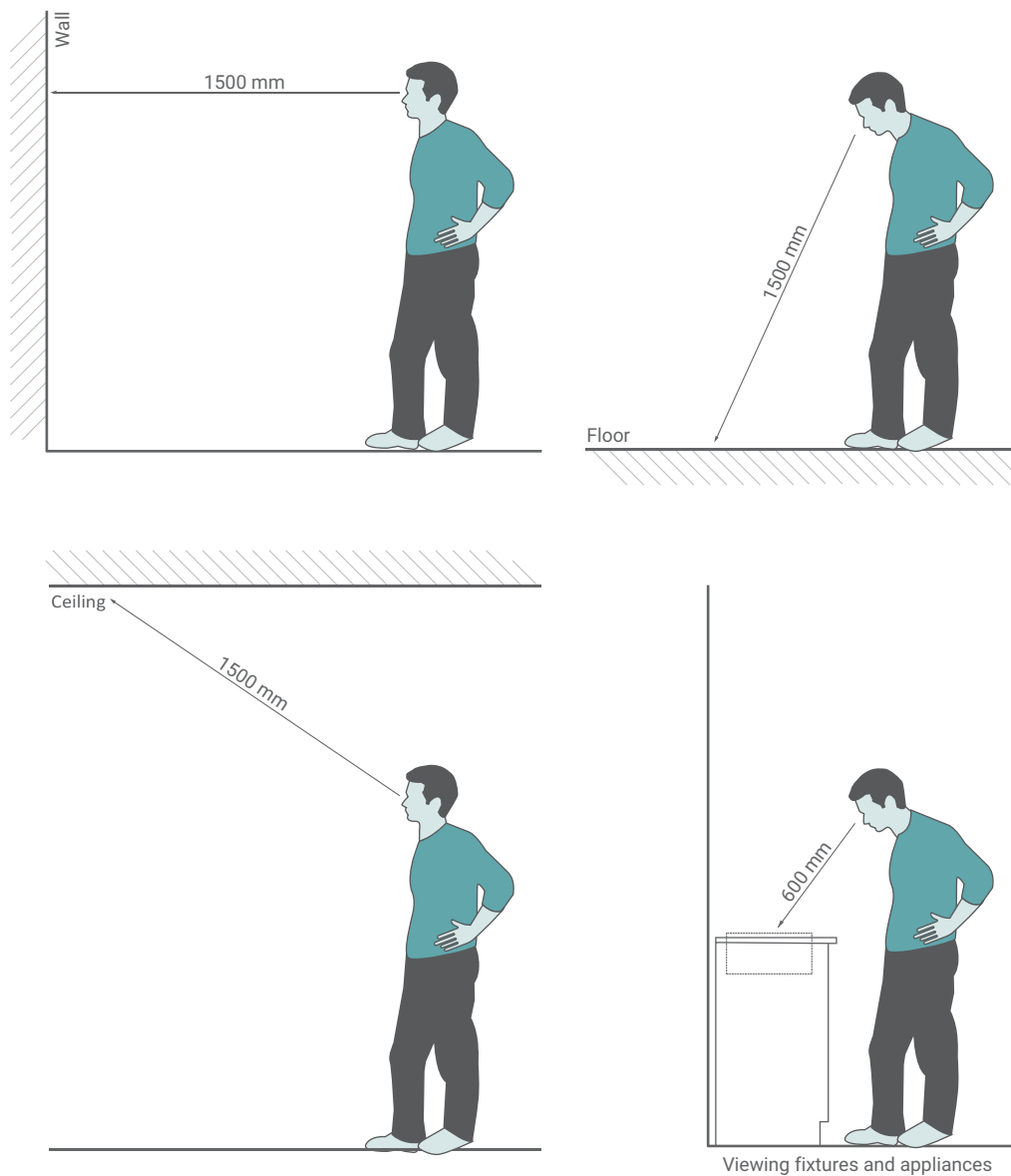

Slight variations in the colour and finish of materials do not always constitute a defect.

1 Non-critical light is defined in appendix.B3 and D7 Australian Standard AS/NZS 2589. Refer also to CSIRO TR 90/1, Report No. L8 – 1992.